





SCENIC SPACE-SHIPS

- 1 Diamond Deck**
Featuring the pinnacle of our luxuriously appointed Royal, Junior and Balcony Suites, the Diamond Deck also hosts Portobellos Restaurant and the River Café.
- 2 Sapphire Deck**
As well as our Deluxe Balcony Suites, Junior Suites and Balcony Suites, the Sapphire Deck is home to fine dining at Table La Rive and Crystal Dining.
- 3 Jewel Deck**
A small selection of Standard Suites and the Wellness and Fitness Center are located on the Jewel Deck.
- 4 Balcony Suites**
Balcony Suites with Scenic sun lounges. Watch the world glide by from your private Scenic sun lounge.
- 5 Standard Suites**
Standard suites are located on the Jewel Deck with picture windows.
- 6 Wellness Area**
Unwind or stay fit in the wellness area with massages[^], modern gym and the exclusive Salt Therapy Lounge (on select Space-Ships).
- 7 Sun Deck & Riverview Terrace**
The Sun Deck and Riverview Terrace are the perfect spots for 360° views, exercise on the walking track or a relaxing soak in the Vitality Pool (selected ships).
- 8 Panorama Lounge & Bar**
Take a seat in the heart of the ship and enjoy a drink with friends old and new. Choose from fine regional wines and beers, spirits, cocktails, mocktails and specialty teas and coffee.
- 9 Crystal Dining**
Our spacious main dining room serves breakfast, lunch and dinner with open seating.
- 10 Portobellos L'Amour**
For just 32 guests each evening. At least once during your cruise, you will receive an invite to dine at Portobellos/L'Amour. The five-course menu features regional specialties paired with local wines.
- 11 Panorama Deck**
Take in the views from the bow of the ship on the Panorama Deck. This is also a great spot to get an up-close view when passing through a ship lock.

Scenic Diamond is used as an example. Please note not all ships are equipped with all amenities or follow the same deck plan. This layout is a general indication only and may vary in some locations. In the event of a deviation some services and inclusions may not be provided in line with these depictions.
[^]At additional cost.

Scenic Ruby & Pearl | Rhine, Main, Danube & Moselle Rivers

Refurbished 2019 | Built 2009/2011 | Length 443 ft. (135 m.) | Guests 159 | Suites 80 | Crew 57 | Gross Tonnage 2,721

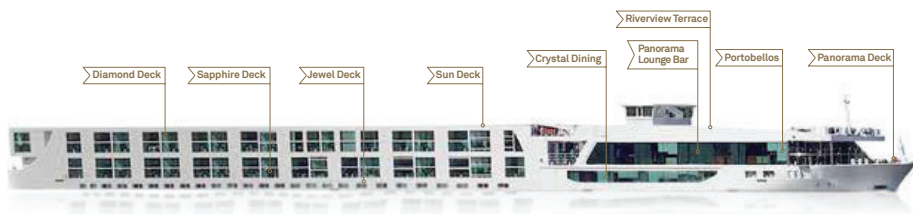

Sun Deck



Diamond Deck

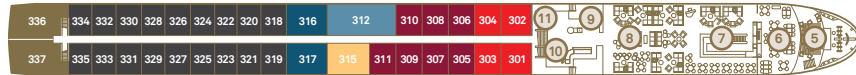

Sapphire Deck

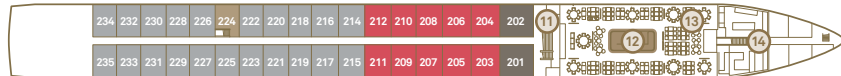

Jewel Deck

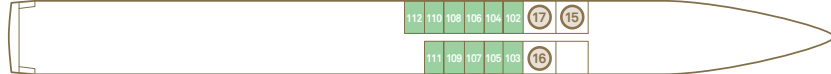

Suite Categories

CAT	Diamond Deck	Qty	Size	CAT	Sapphire Deck	Qty	Size
RS	Royal Panorama Suite	2	420 sq.ft. / 39 sq. m.	C	Balcony Suite	21	215 sq.ft. / 20 sq. m.
A	Balcony Suite	18	247 sq.ft. / 23 sq. m.	BS	Single Balcony Suite	1	183 sq.ft. / 17 sq. m.
RA	Royal Balcony Suite	2	215 sq.ft. / 20 sq. m.	B	Balcony Suite	10	215 sq.ft. / 20 sq. m.
R	Royal Balcony Suite	1	215 sq.ft. / 20 sq. m.	BJ	Junior Balcony Suite	2	215 sq.ft. / 20 sq. m.
RO	Royal Owner's Suite	1	520 sq. ft. / 48 sq. m.				
P	Balcony Suite (Ruby)	9	247 sq.ft. / 23 sq. m.	CAT	Jewel Deck	Qty	Size
P	Balcony Suite (Pearl)	7	247 sq.ft. / 23 sq. m.	E	Standard Suite	11	172 sq.ft. / 16 sq. m.
RJ	Junior Balcony Suite (Ruby)	2	215 sq.ft. / 20 sq. m.				
RJ	Junior Balcony Suite (Pearl)	4	215 sq.ft. / 20 sq. m.				

Scenic Pearl Balcony Suites 303 & 304 are RJ Balcony Suites. Images shown are a representation and actual deck plan and suite layout may vary. Deck plans shown are for 2025 Europe sailings and beyond. For 2024 versions, please visit scenicusa.com.

Deck Plan

- ① Riverview Terrace
- ② Wheelhouse
- ③ Sun Deck
- ④ Walking Track
- ⑤ Panorama Deck
- ⑥ Portobellos Restaurant
- ⑦ River Café
- ⑧ Panorama Lounge & Bar
- ⑨ Gift Shop
- ⑩ Reception
- ⑪ Elevator
- ⑫ Crystal Dining
- ⑬ Table La Rive
- ⑭ Galley
- ⑮ Wellness Area
- ⑯ Salt Therapy Lounge
- ⑰ Fitness Center



Standard Suite

160 sq. ft./15 sq. m

E

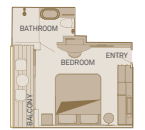

Balcony Suite

205 sq. ft./19 sq. m.

Including Scenic Sun Lounge

A P C B



Royal Balcony Suite

315 sq. ft./29 sq. m.

Including Scenic sun lounge

R

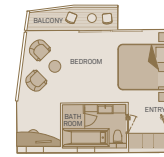

Royal Panorama Suite

325 sq. ft./30 sq. m.

Including Scenic sun lounge

RS

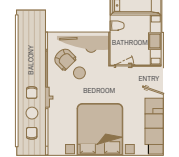

Junior Balcony Suite

250 sq. ft./23 sq. m.

Including Scenic sun lounge

RJ BJ

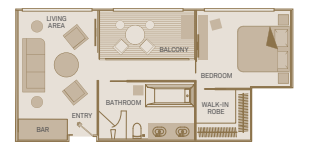

Royal Owner's Suite

520 sq. ft./48 sq. m.

One bedroom suite including Scenic sun lounge

RO