

WELCOME
ON BOARD

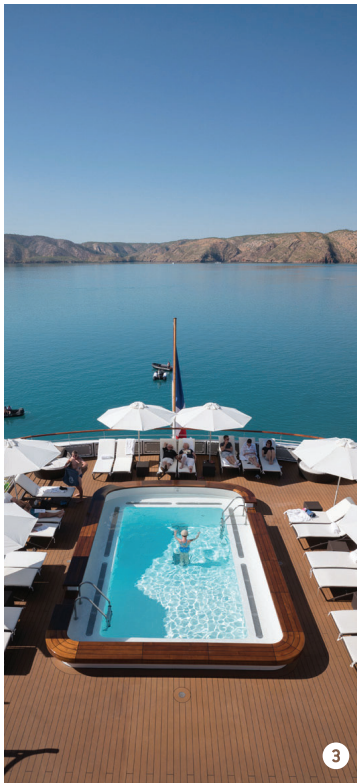

The Sisterships

As yachts on a human scale, with just 122 or 132 staterooms *L'Austral*, *Le Boréal*, *Le Lyrial*, and *Le Soléal* can gain access to isolated places and ports reserved for small vessels.

They are thus faithful to the PONANT DNA: **exploring the world** with constantly renewed curiosity.





6



7



8



9

6. L'Austral

7. Prestige Stateroom, Le Lyrial

8. Prestige Stateroom Balcony, Le Boréal

9. Prestige Stateroom, L'Austral

1. Spa, Le Lyrial

2. The gastronomic restaurant, deck 2, Le Lyrial

3. The swimming pool on deck 6

4. The library

5. The Observatory lounge, Le Soléal

Amenities

Individually controlled air conditioning

Stateroom layout: king-size bed, or twin beds, adjoining staterooms available

Minibar

Flat-screen satellite TV

Video on demand

Bose Bluetooth speaker

Safe

Diptyque bath products

Dressing table, bathrobes, hairdryer

Direct line telephone

110V American (two flat pins)/220V European (round sockets with two round pins)

24-hour room service

Inclusive Wifi internet access*

**Depending on the navigation areas, the Wifi may not be accessible for reasons beyond our control.*

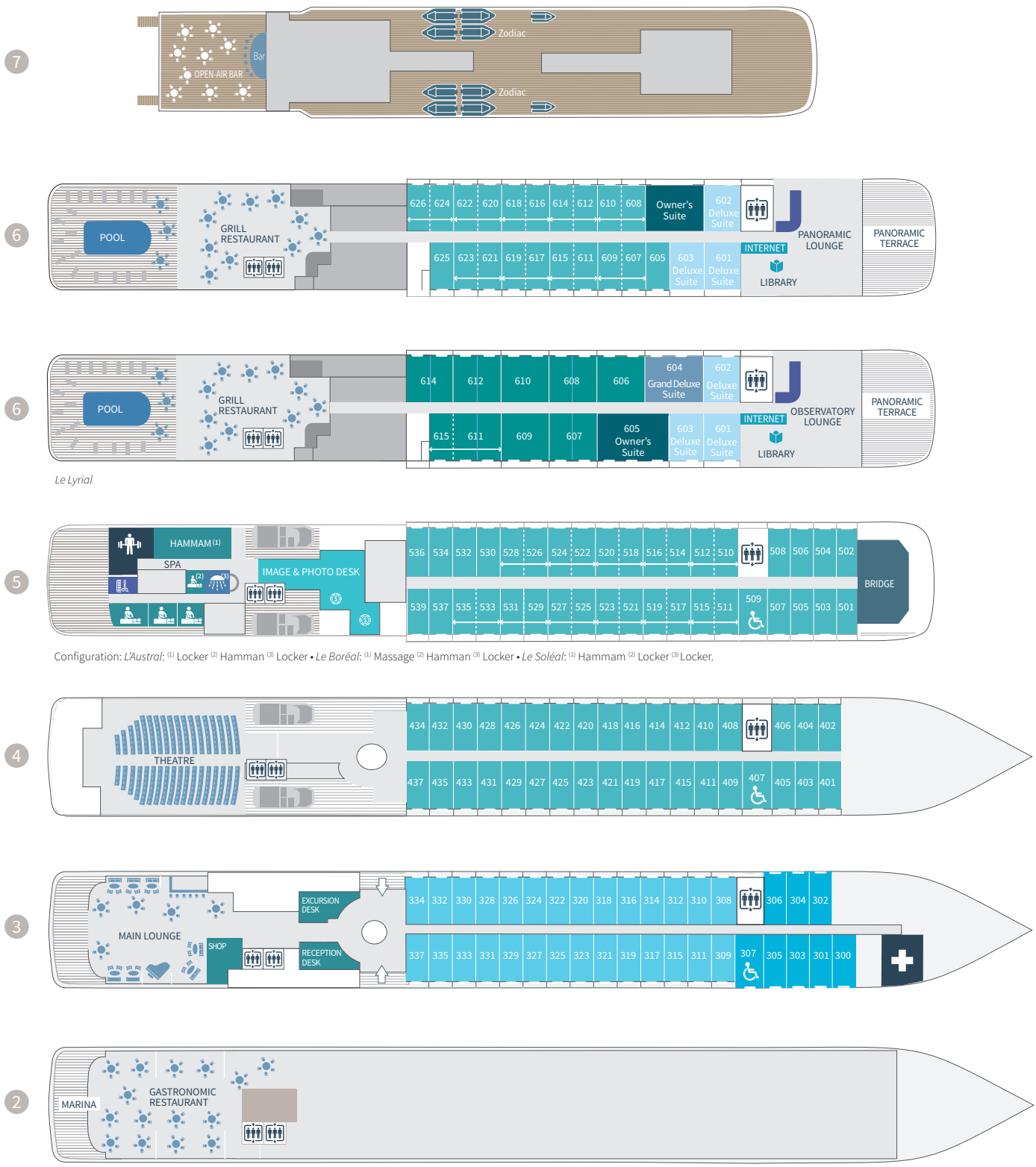

Le Lyrial

Configuration: L'Austral: (1) Locker (2) Hamman (3) Locker • Le Boréal: (1) Massage (2) Hamman (3) Locker • Le Soléal: (1) Hamman (2) Locker (3) Locker.

Scan here for immediate embarkation on board our Sisterships.

- Owner's Suite
Deck 6
- Grand Privilege Suite
Deck 6 (*Le Lyrial*)
- Privilege Suites
Deck 6 (*Le Lyrial*)
- Prestige Suites
Deck 5 - 6 (except *Le Lyrial*)
- Grand Deluxe Suite
Deck 6 (*Le Lyrial*)
- Deluxe Suites
Deck 6
- Prestige Staterooms
Deck 4 - 5 - 6
- Deluxe Staterooms
Deck 3
- Superior Staterooms
Deck 3

Discover your Stateroom

OWNER'S SUITE aboard *Le Lyréal*

(55 sq.m/581 sq.ft + 12 sq.m/129 sq.ft private balcony with sliding bay windows)

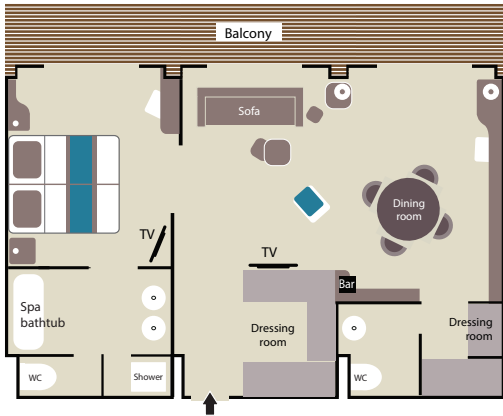

GRAND PRIVILEGE SUITE aboard *Le Lyréal*

(55 sq.m/581 sq.ft + 12 sq.m/129 sq.ft private balcony with sliding bay windows)

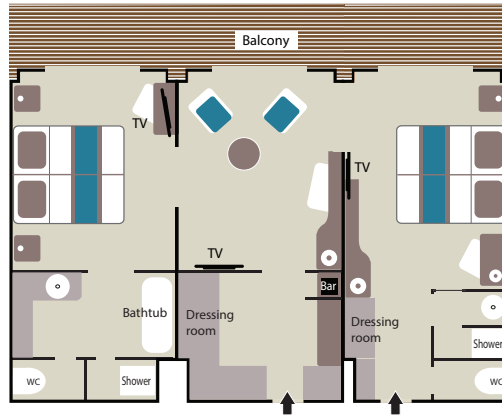

PRIVILEGE SUITE aboard *Le Lyréal*

(37 sq.m/388 sq.ft + 8 sq.m/86 sq.ft private balcony with sliding bay windows)

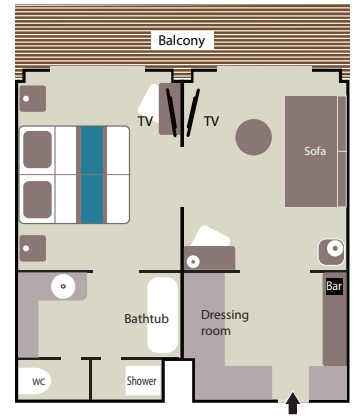

OWNER'S SUITE

(45 sq.m/484 sq.ft + 9 sq.m/97 sq.ft private balcony with sliding bay windows)

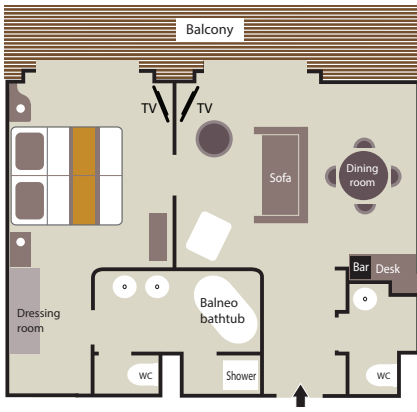

GRAND DELUXE SUITE aboard *Le Lyréal*

(45 sq.m/484 sq.ft + 10 sq.m/108 sq.ft private balcony with sliding bay windows)

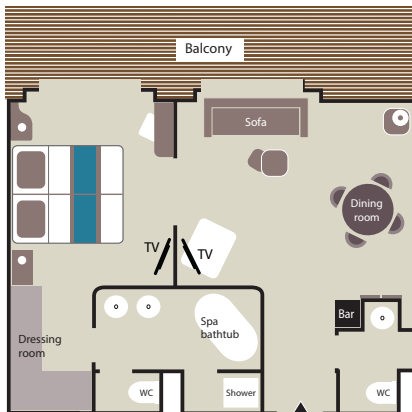

PRESTIGE SUITE

(37 sq.m/398 sq.ft + 8 sq.m/86 sq.ft private balcony with sliding bay windows)

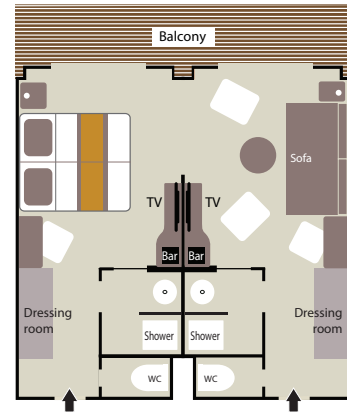

Prestige Suites aboard *Le Boréal* & *Le Soléal*: 1 shower and 1 bathtub.

DELUXE SUITE

(27 sq.m/290 sq.ft + 6 sq.m/64 sq.ft private balcony with sliding bay window)

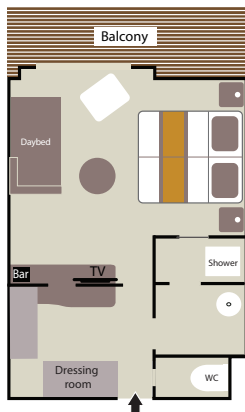

Deluxe Suites aboard *Le Boréal*: 1 shower and 1 bathtub

PRESTIGE STATEROOM

(18.5 sq.m/200 sq.ft + 4 sq.m/43 sq.ft private balcony with sliding bay window)

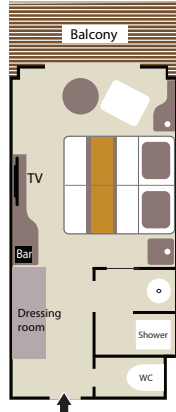

Deck 5-6

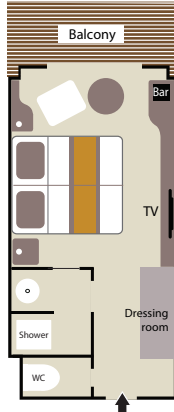

Prestige Staterooms aboard *Le Boréal* & *Le Soléal*, decks 5 & 6: 1 shower or bathtub depends on cabins

DELUXE STATEROOM

(18 sq.m/200 sq.ft + 4 sq.m/43 sq.ft private balcony with French window)

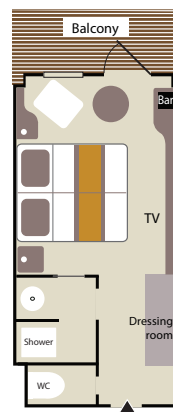

SUPERIOR STATEROOM

(21 sq.m/226 sq.ft)

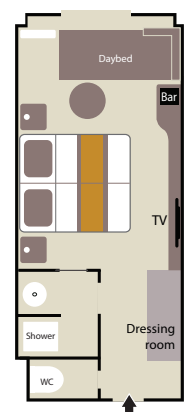



The PONANT
Explorers

Equipped with only 92 staterooms, an underwater lounge, the *Blue Eye*, and the latest technologies to limit the impact on the environment, *Le Bellot*, *Le Bougainville*, *Le Champlain*, *Le Dumont-d'Urville*, *Le Jacques-Cartier*, and *Le Lapérouse* enable you to make stopovers in remote regions.

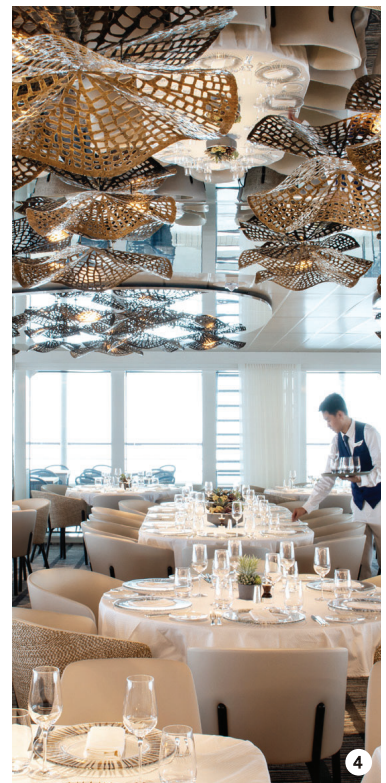



- 1. The Blue Eye, underwater lounge
- 2. The Spa, in partnership with Sothys or Clarins
- 3. The pool deck and its solarium
- 4. The panoramic restaurant, open to the outside
- 5. The theatre, where conferences, shows and performances take place

- 6. *Le Lapérouse*
- 7. The Owner's Suite
- 8. The Owner's Suite, its private terrace and hot tub
- 9. Privilege Suite living room – *Le Bougainville*

Amenities

Individually controlled air conditioning
 Stateroom layout: king-size bed, or twin beds, adjoining staterooms available
 Minibar
 Flat-screen satellite TV
 Video on demand
 Bose Bluetooth speaker
 Safe

Diptyque or Clarins bath products
 Dressing table, bathrobes, hairdryer
 Direct line telephone
 110V American (two flat pins)/220V European (round sockets with two round pins)
 24-hour room service
 Inclusive Wifi internet access*

**Depending on the navigation areas, the Wifi may not be accessible for reasons beyond our control.*

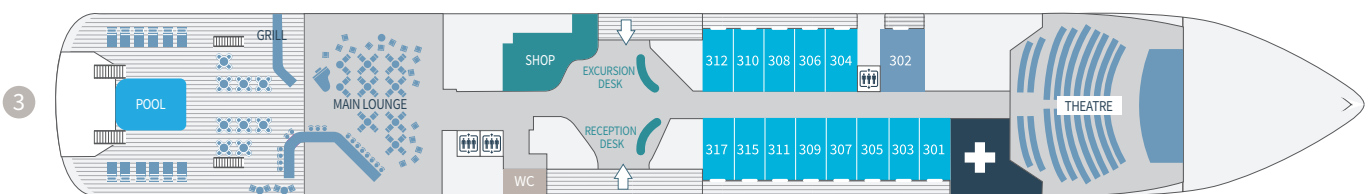
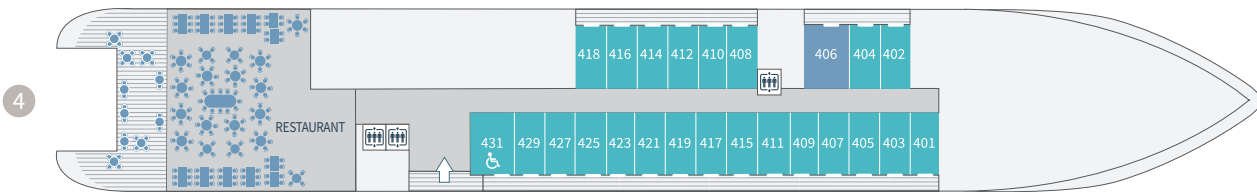
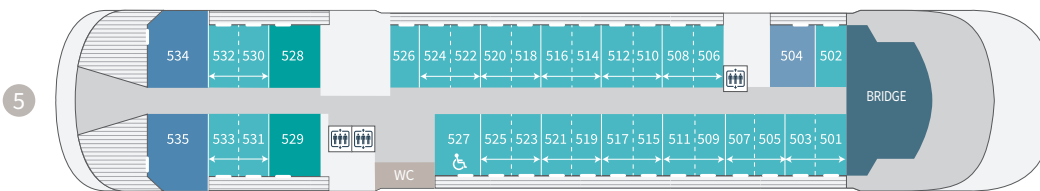
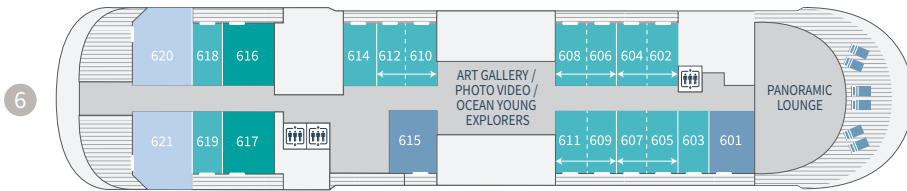
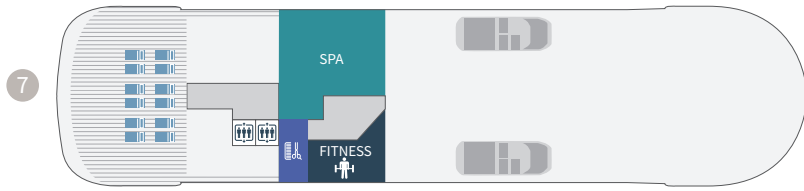

- Owner's Suites Deck 5
- Grand Deluxe Suites Deck 6
- Deluxe Suites Deck 3 - 4 - 5 - 6
- Deluxe Staterooms Deck 3
- Privilege Suites Deck 5 - 6
- Prestige Suites Deck 5 - 6
- Prestige Staterooms Deck 4 - 5 - 6

Discover your Stateroom

OWNER'S SUITE

(45 sq.m/484 sq.ft + 40 sq.m/430 sq.ft private terrace with hot tub and sliding bay windows)

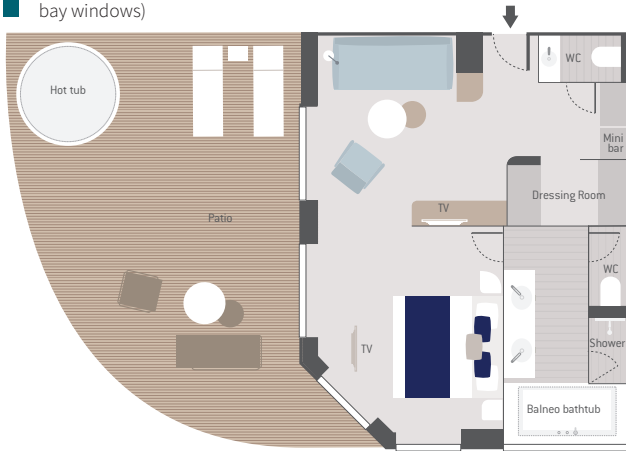

GRAND DELUXE SUITE

(45 sq.m/484 sq.ft + 30 sq.m/323 sq.ft private terrace with sliding bay windows)

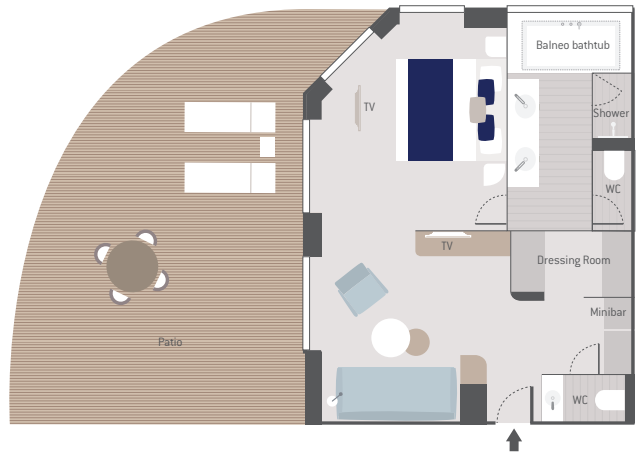

PRIVILEGE SUITE

(32 sq.m/344 sq.ft + 8 sq.m/86 sq.ft private balcony with sliding bay window)



PRESTIGE SUITE

(38 sq.m/409 sq.ft + 8 sq.m/86 sq.ft private balcony with sliding bay window)

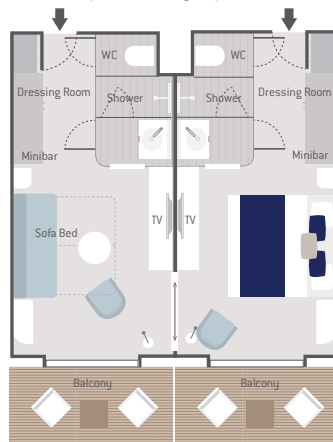

PRESTIGE STATEROOM

(19 sq.m/204 sq.ft + 4 sq.m/43 sq.ft private balcony with sliding bay window)



DELUXE SUITE

(27.5 sq.m /291 sq.ft + 6 sq.m/65 sq.ft private balcony with sliding bay window)

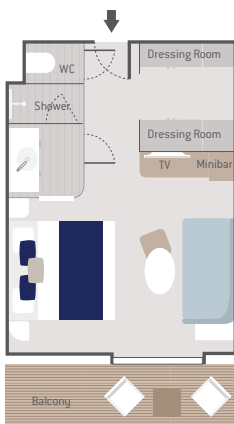

DELUXE STATEROOM

(19 sq.m/204 sq.ft + 4 sq.m/43 sq.ft private balcony with French window)

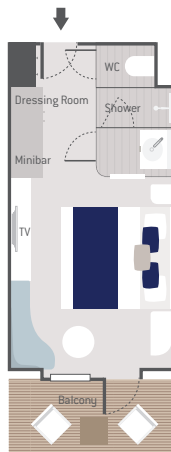

Scan here for immediate embarkation on board the PONANT Explorers.



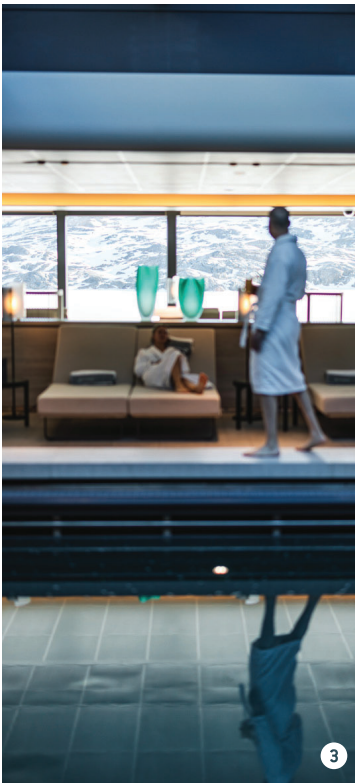

Le Commandant Charcot

As the first **hybrid electric-liquefied natural gas** polar exploration ship, *Le Commandant Charcot* encapsulates an **eco-friendly design** never before seen in the polar regions.

Furnished with 123 staterooms, in total communion with nature, it will carry you safely and comfortably beyond known lands.

Two research laboratories on board enable scientists to collect data that will increase our knowledge of the poles.

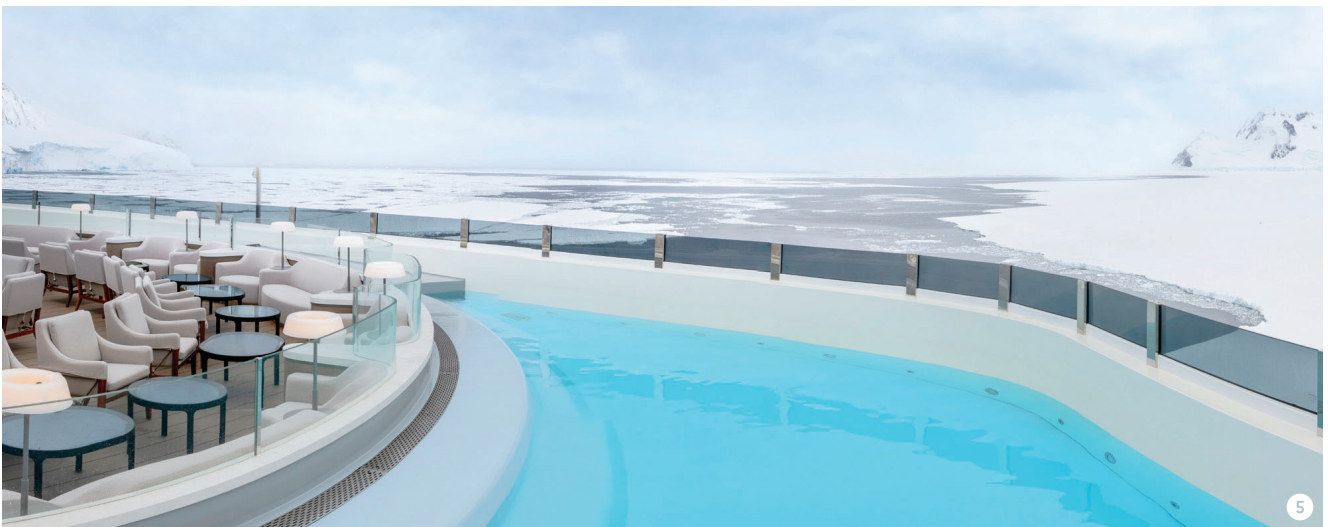
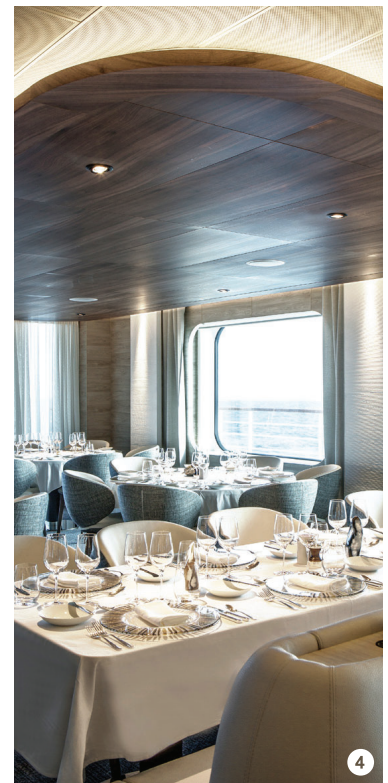



1. The sauna in the wellness area, which also includes the Biological Recherche Spa, hair and nail salon, fitness room, snow cabin
2. The Observatory lounge, deck 9
3. The relaxation area, with a heated indoor swimming pool and a detox bar
4. Nuna Gastronomic Restaurant, Alain Ducasse's only restaurant at sea
5. The Blue Lagoon area, deck 9

6. *Le Commandant Charcot*
7. The Owner's Suite patio, deck 8
8. The sleeping area on the Duplex Suite
9. The Owner's Suite living room, deck 8

Amenities

- Private balcony for all our staterooms and suites
- Terrace for the Duplex Suites and the Owner's Suite
- Butler service and priority boarding: Owner's, Duplex, Privilege, and Grand Prestige Suites
- Individually controlled air conditioning
- Stateroom layout: king-size bed, or twin beds, adjoining staterooms available
- Minibar and 24-hour room service
- Satellite TV channels (availability dependent on navigation)

- Videos on demand
- Bose Bluetooth speaker
- Safe
- Selection of Diptyque bath products
- Dressing table, bathrobes, hairdryer
- Direct line telephone
- 110V American (two flat pins)/220V European (round sockets with two round pins)
- Inclusive Wifi internet access*

**Depending on the navigation areas, the Wifi may not be accessible for reasons beyond our control.*

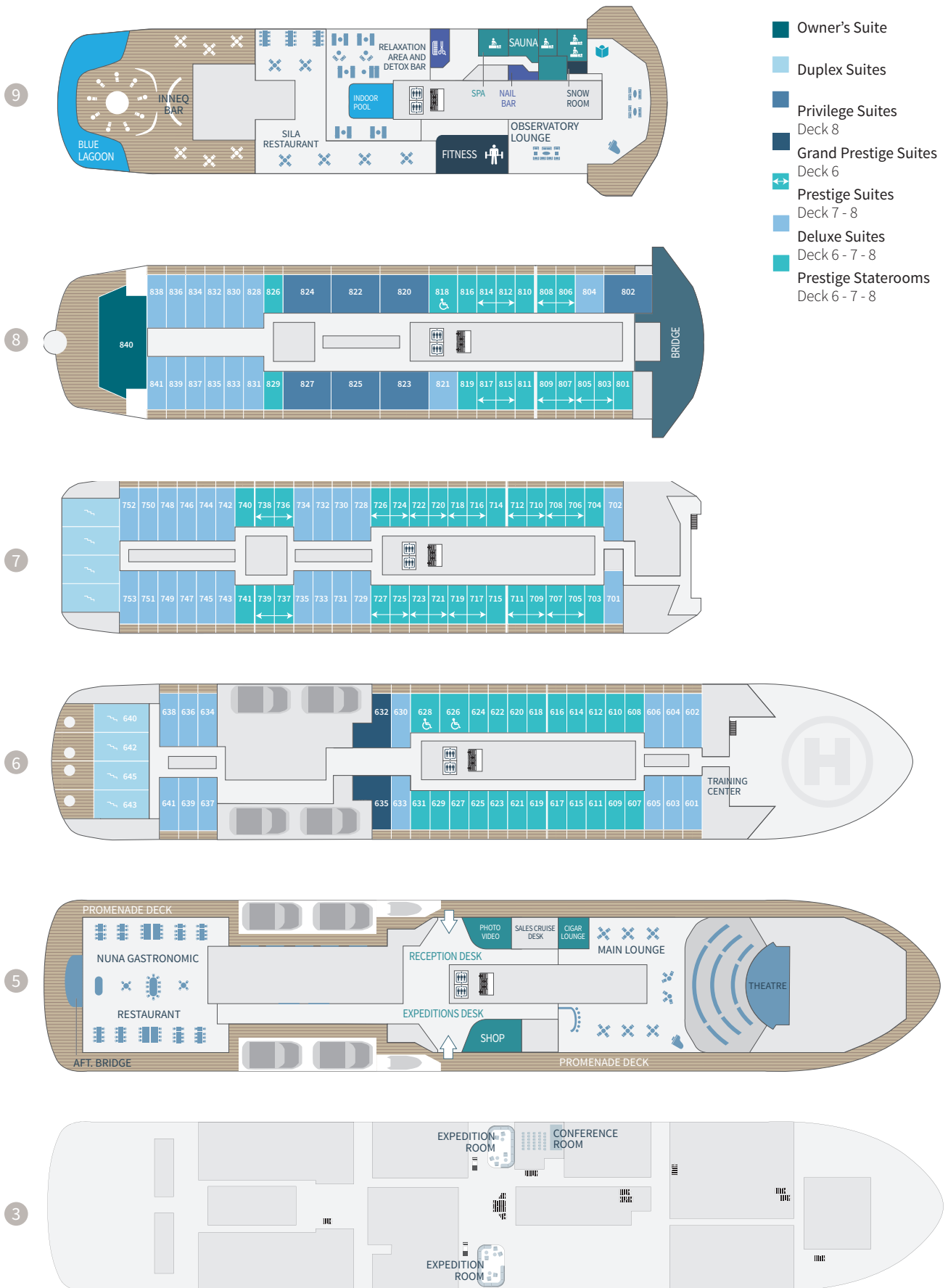

Discover your Stateroom

OWNER'S SUITE (115 sq.m/1,237 sq.ft + 186 sq.m/2,002 sq.ft private terrace
with hot tub • balneo bathtub)

GRAND PRESTIGE SUITE
(42 sq.m/452 sq.ft + 5 sq.m/54 sq.ft
private balcony)

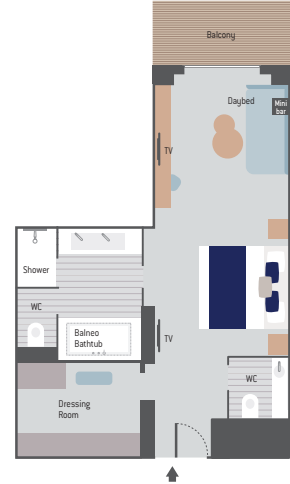
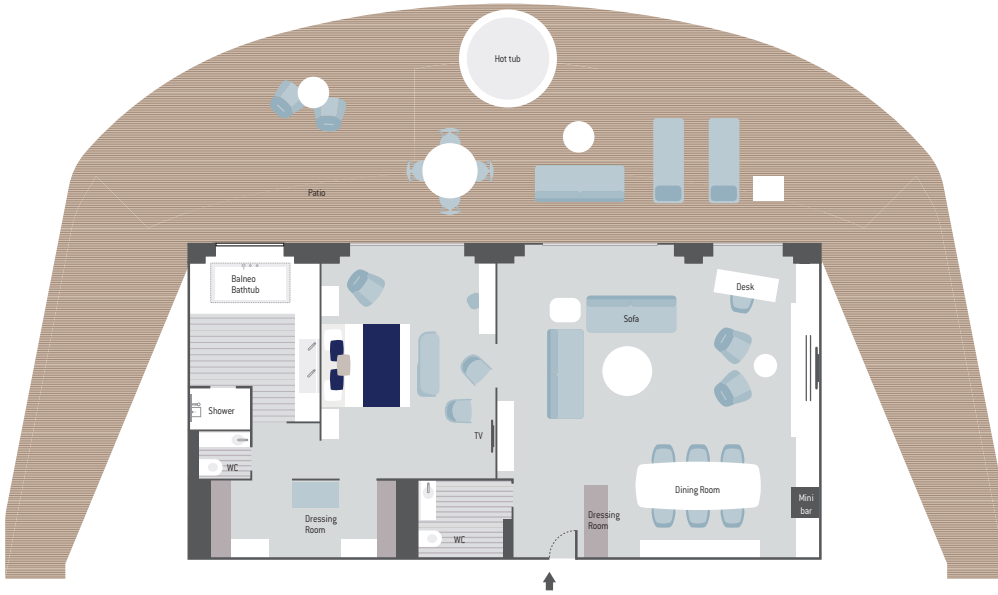

PRIVILEGE SUITE
(48 sq.m/516 sq.ft + 12.5 sq.m/134.5 sq.ft
private balcony • balneo bathtub)



PRESTIGE SUITE
(40 sq.m/430 sq.ft + 10 sq.m/107 sq.ft
private balcony)

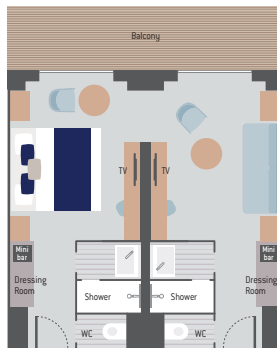

DUPLEX SUITE
(94 sq.m/1,011 sq.ft + 26 sq.m/279 sq.ft private terrace
with hot tub • balneo bathtub)

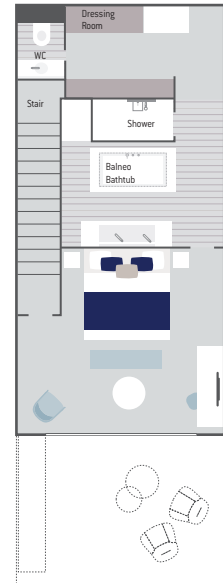
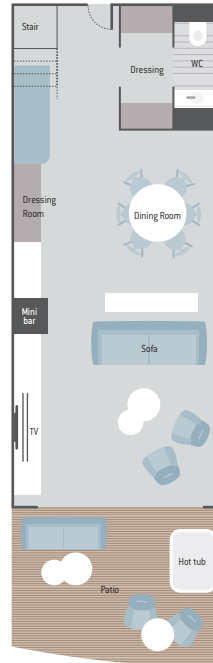

DELUXE SUITE
(28 sq.m/301 sq.ft + 5 sq.m/53 sq.ft private
balcony)



PRESTIGE STATEROOM
(20 sq.m/215 sq.ft + 5 sq.m/53 sq.ft
private balcony)

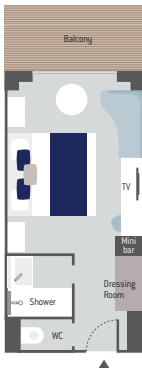

Scan here for immediate
embarkation on board
Le Commandant Charcot.



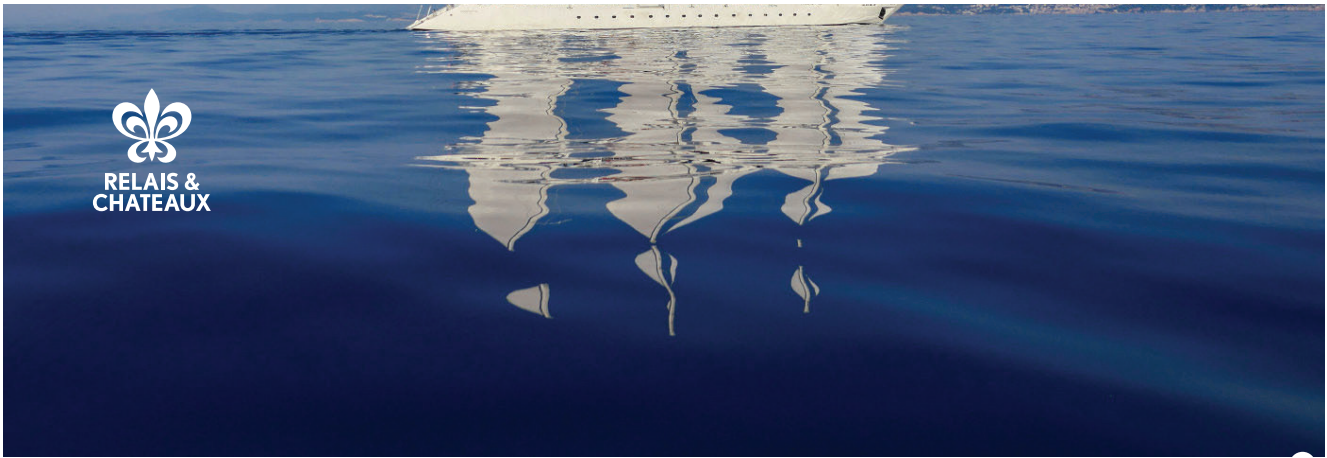

Le Ponant

It is with this ship that the **PONANT adventure began** more than 35 years ago. Furnished with 16 staterooms and suites, *Le Ponant* reinvents the cruise by going with the flow. Enjoy exceptional moments aboard the **first Relais & Châteaux sailing yacht**, as though you were on your own private yacht. Whether you're passionate about sailing or a fan of *la dolce vita*, you will enjoy the pleasure of a seamless reconnection with the elements.

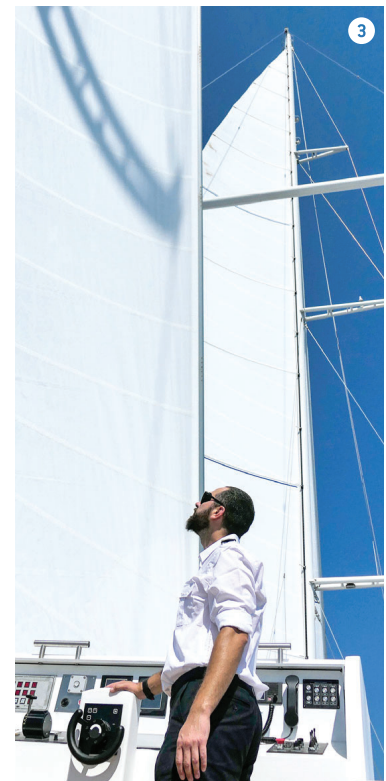



5



6



7



8

1. Le Ponant

2. The Sun Lounge area on the Sun Deck

3. Navigation under sail whenever conditions allow

4. Alizés Grand Privilege Suite, with balcony

5. Sun Deck

6. The Marina on Alizés Deck, with its saltwater swimming pool and watersports equipment

7. The lounge and bar Émeraude on Alizés Deck

8. Fine gastronomic cuisine made using high quality, organic and local products

Amenities

Individually controlled air conditioning
 Stateroom layout: king-size bed, or twin beds, adjoining staterooms available
 Minibar
 Flat-screen satellite TV
 Video on demand
 Bose Bluetooth speaker
 Safe

Diptyque bath products
 Dressing table, bathrobes, hairdryer
 Direct line telephone
 110V American (two flat pins)/220V European (round sockets with two round pins)
 24-hour room service
 Inclusive Wifi internet access*

**Depending on the navigation areas, the Wifi may not be accessible for reasons beyond our control.*

SUN DECK

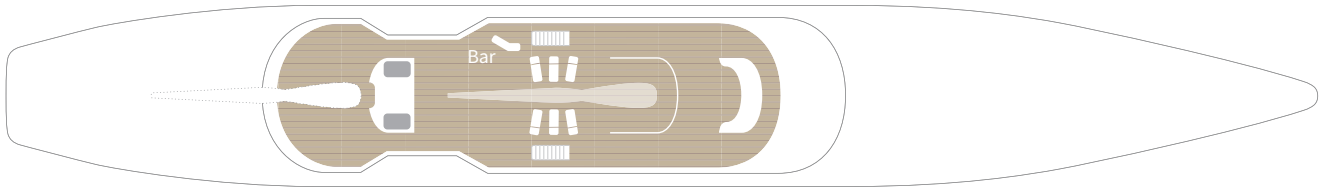

ZEPHYR DECK

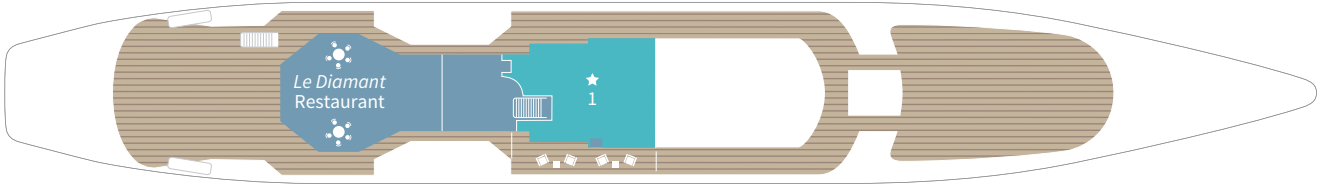

ALIZÉS DECK

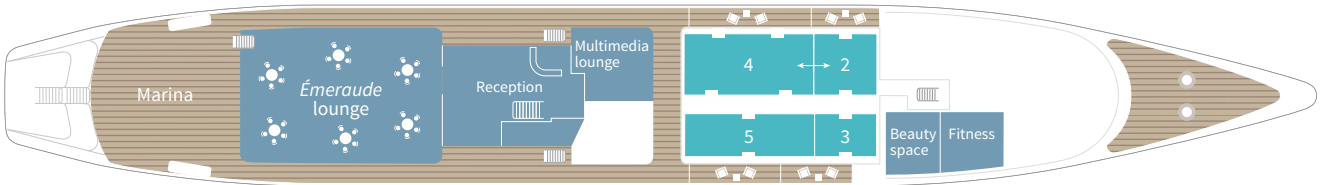

MISTRAL DECK



- 1 Owner Suite with balcony
- 2 Alizés Stateroom with balcony
- 3 and 5 Alizés Privilege Suite with balcony
- 4 Alizés Privilege Suite with balcony
- 4 + 2 Alizés Grand Privilege Suite with balcony

- 6 and 16 Mistral Stateroom
- 7, 9, 12, 14, 15 and 17 Mistral Prestige Stateroom
- 8 and 11 Mistral Junior Suite
- 10 Mistral Prestige Suite

Discover your Stateroom

OWNER'S SUITE

(47 sq.m/506 sq.ft + 9 sq.m/97 sq.ft private balcony)

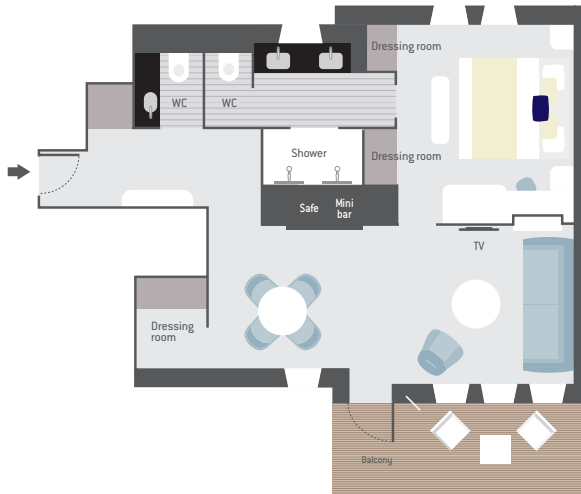

PRESTIGE MISTRAL SUITE

(27 sq.m/291 sq.ft + porthole)

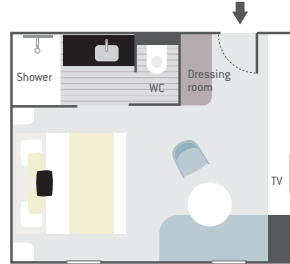

JUNIOR MISTRAL SUITE

(22 sq.m/237 sq.ft + porthole)

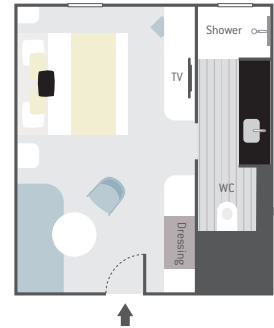

PRESTIGE MISTRAL STATEROOM

(16 sq.m/172 sq.ft + porthole)

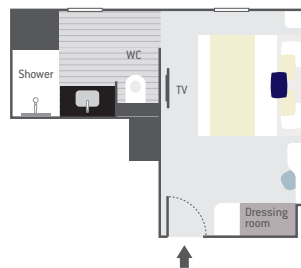

MISTRAL STATEROOM

(14 sq.m/151 sq.ft + porthole)

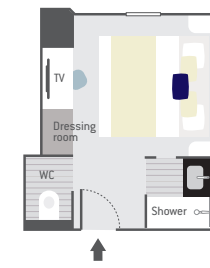

ALIZÉS GRAND PRIVILEGE SUITE

(49 sq.m/527 sq.ft + 13 sq.m/140 sq.ft private balcony)

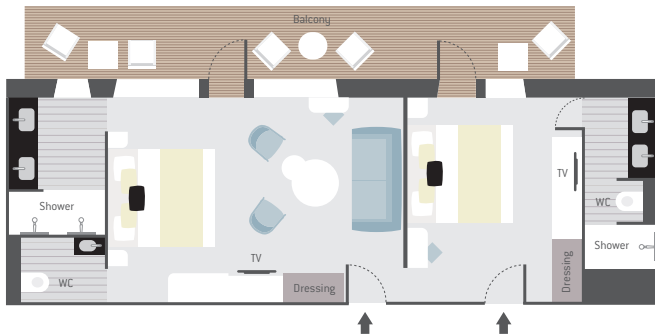

ALIZÉS PRIVILEGE SUITE

(30 sq.m/323 sq.ft + 9 sq.m/97 sq.ft private balcony)

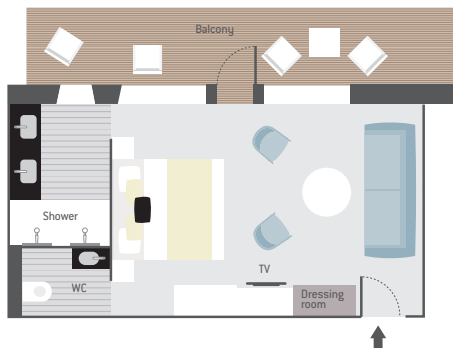

ALIZÉS STATEROOM

(19 sq.m/205 sq.ft + 4 sq.m/43 sq.ft private balcony)

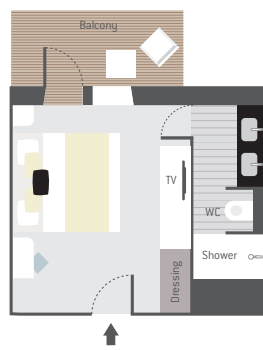

ALIZÉS PRESTIGE STATEROOM

(16 sq.m/172 sq.ft + 8 sq.m/86 sq.ft private balcony)

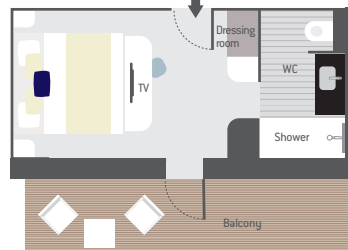

Scan here for
immediate embarkation
on board *Le Ponant*.



PONANT EXPLORERS

Le Bellot, Le Bougainville, Le Champlain, Le Dumont-d'Urville, Le Jacques-Cartier & Le Lapérouse



The PONANT Explorers series is designed to enable you to experience the expedition in a different way. Equipped with an underwater lounge, the Blue Eye, and the latest technologies to limit the impact on the environment, *Le Bellot, Le Bougainville, Le Champlain, Le Dumont-d'Urville, Le Jacques-Cartier, and Le Lapérouse* grant you the ability to make stopovers in remote regions.

Ship Specifications

- Length 430 ft.
- Beam 26 ft.
- Draft 15 ft.
- Average cruising speed ... 12.5 knots
- Ice Class 1C
- Classification Bureau Veritas
- Flag French
- Guest Decks 5
- Crew members 110
- Guest capacity up to 184 guests (double occupancy)
- Staterooms with balcony . 88
- Suites with bay windows and terrace 4
- Zodiacs (Mark V HD) 10 Zodiaccraft
- Boston Whaler-type boats 1
- Gross tonnage 9,900 UMS
- Stabilizers (2) 13.1 ft. long x 4.7 ft. wide
- Construction VARD, Norway

Stateroom Amenities

- Individually controlled air-conditioning
- King-size bed, or two beds, adjoining rooms available (for families with children)
- Minibar (unlimited drinks, replenished every day)
- Flat-screen TV, television channels via satellite
- On-demand video
- Desk with writing pad
- Electronic safe
- Selection of French bath products
- Dressing table and hairdryer
- Direct telephone line via satellite
- 110/220 volt outlets
- 24-hour room service
- WiFi Internet access

THE SISTERSHIPS

L'Austral, Le Boréal, Le Lyrial & Le Soléal



With their slender lines and understated decor, PONANT's Sisterships offer a luxurious and responsible way to explore some of the most beautiful and remote parts of the world. Since these yachts were built on a human scale, *L'Austral, Le Boréal, Le Lyrial*, and *Le Soléal* can gain access to isolated places and ports.

They are faithful to the PONANT DNA: exploring the world with constantly renewed curiosity and responsibility.

Ship Specifications

- Length466 ft.
- Beam59 ft.
- Draft15.3 ft.
- Cruising Speed14 knots
- Ice class.....1 C
- Classification Bureau Veritas
- Flag.....French
- Guest Decks6
- Guest capacity up to 264 guests
(double occupancy) (up to 244 guests on *Le Lyrial*)
- Normal Crew Size140
- Zodiacs(Mark V HD)
.....12 Zodiac craft
- Gross tonnage10,944 UMS
- Stabilizers (2)13.1 ft. long x 4.7 ft. wide
- Electric motors2 x 2,300 KW
- Installed power6,400 KW
- ConstructionFincantieri-Ancona, Italy

Stateroom Amenities

- Individually-controlled air-conditioning
- King-size bed, or two beds, adjoining cabins available (Children welcome)
- Minibar
- Flat screen satellite TV
- iPod™ players
- Desk with stationery
- Safe
- French bath products
- Dressing table, bath robes, hairdryer
- Direct line telephone
- Outlets: 110V American (two flat pins) /220V European (round sockets with two round pins)
- 24-hour room service
- WiFi Internet access